

Arrow Industrial Center

Arrow Route between Central & Benson Avenue
Upland, CA 91786



Project Features

- 5 multi-tenant industrial buildings and 1 free-standing two-story office building
- Easy access to Foothill Blvd., Interstates 10 and 210
- Multi-tenant buildings have front 12' x 12' overhead roll-up doors with ground-level loading
- Each unit has a 100 amp 3-phase panel
- Central air conditioned and heated offices
- Ample parking
- Competitive lease rates



Contact: Mauricio Letona / (909) 949-6791 / mauricio.letona@lewismc.com

Lewis Commercial

1156 N. Mountain Avenue, Upland, CA 91786
lewisgroupofcompanies.com/OfficeIndustrial

Arrow Industrial Center

ARROW ROUTE BETWEEN CENTRAL & BENSON AVENUE • UPLAND, CALIFORNIA

BUILDING A

1785 ARROW ROUTE

Size: 2,000 sq. ft. to 4,000 sq. ft.
4,000 Sq. ft. two-story free standing office building
2,000 Sq. ft. per floor

BUILDING B

1785 ARROW ROUTE

Size: 1,818 sq. ft. to 11,434 sq. ft.
Office: 171 sq. ft.
Power: 120/208 volts, 3 phase, 200 amps
Loading: Minimum one 12' x 12' ground level
Clearance: 16' minimum

BUILDING D

1785 ARROW ROUTE

Size: 1,818 sq. ft. to 9,761 sq. ft.
Office: 171 sq. ft.
Power: 120/208 volts, 3 phase, 200 amps
Loading: Minimum one 12' x 12' ground level
Clearance 16' minimum

BUILDING E

1785 ARROW ROUTE

Size: 1,818 sq. ft. to 9,199 sq. ft.
Office: 171 sq. ft.
Power: 120/208 volts, 3 phase, 200 amps
Loading: Minimum one 12' x 12' ground level
Clearance: 16' minimum

BUILDING F

1777 WOODLAWN STREET

Size: 1,895 sq. ft. to 3,790 sq. ft. Can be divided into two 1,895 sq. ft. spaces
Office: 171 sq. ft.
Power: 120/208 volts, 3 phase, 200 amps
Loading: Minimum one 12' x 12' ground level
Clearance: 16' minimum

BUILDING G

1777 WOODLAWN STREET

Size: 1,011 sq. ft. to 46,442 sq. ft.
Office: 171 sq. ft.
Power: 120/208 volts, 3 phase, 200 amps
Loading: Minimum one 12' x 12' ground level
Clearance: 16' minimum

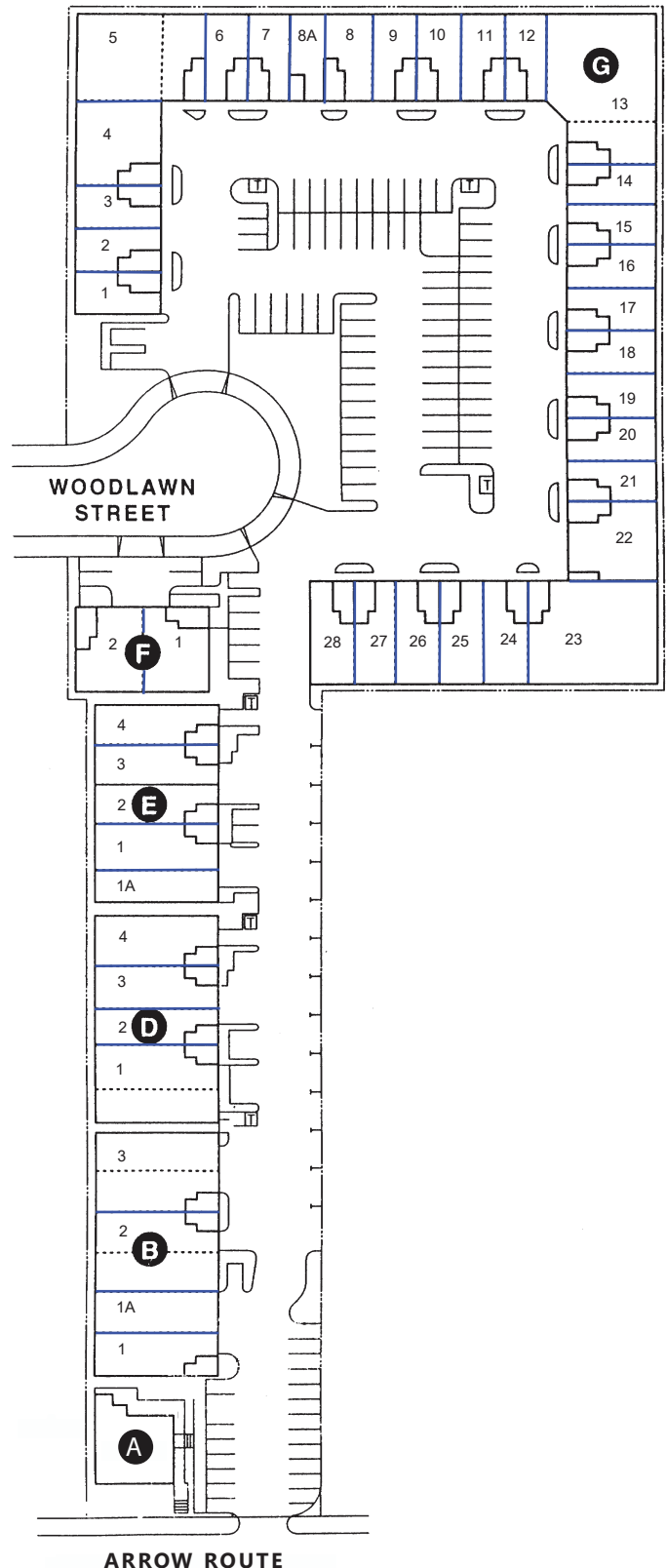

Lewis Commercial
A Member of the Lewis Group of Companies